



BIONIC® Plus combination anthelmintic and mineral capsule for 40 to 80 kg sheep.

CONTAINS

A macrocyclic lactone (ML) and a benzimidazole (BZ). This means that the capsule delivers two different drench actives that work in different ways to kill parasites. Each capsule contains 185 mg of abamectin (ML) and 4.62 g of albendazole (BZ). Each capsule also contains the trace minerals selenium (24 mg) and cobalt (118 mg).

TREATMENT AND CONTROL

Treats established infections and prevents new infections of internal parasites sensitive to either or both of the ML and BZ drug families for an average of 100 days (range 85 to 115). Newly ingested infective larval stages of dual resistant parasite strains (benzimidazole + macrocyclic lactone) can remain sensitive to and controlled by BIONIC Plus while the dual resistant adult stages may not be removed. Where such resistant strains exist an effective “clean-out drench” from a different action family can be used immediately prior to BIONIC Plus application to remove the resistant adult stage. Any such concurrent treatment should only be done in consultation with a veterinarian.

BIONIC Plus is effective against sensitive strains or sensitive stages of the following internal parasites: *Haemonchus contortus**, *Teladorsagia [Ostertagia] circumcincta**, *T. trifurcata**, *Trichostrongylus axei**, *T. colubriformis**, *T. vitrinus**, *Cooperia curticei*, *C. oncophora*, *Nematodirus spathiger**, *N. filicollis**, *Chabertia ovina*, *Oesophagostomum* spp., *O. venulosum*, *Trichuris* spp., *Strongyloides papillosus*.

*Includes inhibited L4 larvae.

RECOMMENDED USE

Dose one capsule to sheep of 40 to 80 kg liveweight and two capsules to sheep over 80 kg.

Pregnant ewes – administer the capsule(s) 2-6 weeks prior to lambing. Do not use at the same time as any other selenised fertiliser prill or product and do not exceed the stated dose or frequency without consulting a veterinarian. Do not re-treat within 270 days.

It is accepted practice to target animals experiencing high physiological demands, (e.g. young or old, twin bearing and underweight animals), when treating for parasites. Leaving a percentage of the target population of animals untreated is beneficial in the management of parasite populations in refugia. Concurrent drench treatment with BIONIC Plus capsules should be done in consultation with your local veterinarian to monitor the response to treatment and the ongoing anthelmintic resistance status of the farm. Resistance can develop to any anthelmintic. It is advisable that a drench resistance test be conducted regularly when using any antiparasitic treatment.

BENEFITS

- For the treatment and protection against sensitive strains or sensitive stages of internal parasites for an average of 100 days (range 85 to 115 days)
- Treats established and newly ingested internal parasites that are sensitive to either or both active
- Reduces pasture contamination with parasite larvae
- Aids in the control of dags and associated flystrike caused by internal parasites that can lead to flystrike
- Aids in the reduction of internal parasites in lambs prior to weaning (reduced drench requirement in lambs)
- Contains selenium to treat and prevent deficiency in sheep for 250 days and protect suckling lambs from selenium deficiency until weaning
- Contains Cobalt (vitamin B12) to treat and prevent deficiency in sheep for 100 days and elevates milk vitamin B12 levels in lactating ewes

PROUDLY AVAILABLE FROM YOUR LOCAL PARTICIPATING VETERINARY CLINIC

See product label for full claim details and directions for use. BIONIC® is a registered trademark of Boehringer Ingelheim Vetmedica GmbH, used under license. ACVM Registration No. A011825. © Copyright 2025 Boehringer Ingelheim Animal Health New Zealand Limited. All rights reserved. NZ-OVI-0015-2025.





DIRECTIONS FOR USE

By law the user must take due care, obtaining expert advice when necessary, to avoid unnecessary pain and distress when using the product other than as directed on the label.

TO ENSURE SAFE DOSING OF CAPSULES YOU MUST FOLLOW THESE DIRECTIONS

- Dose one capsule to sheep between 40 kg and 80 kg liveweight
- Sheep should be weighed if liveweight is uncertain (weight of fleece may be deducted to calculate target liveweight)
- Do not under-dose
- For dosing, fit the flat end of the capsule into the cup on the BIONIC Plus applicator
- Avoid the teeth as biting the capsule may cause damage that could affect the performance of the capsule
- Do not remove the tape from the capsule and ensure the applicator is in good working condition
- After releasing the capsule and during removal of the applicator from the mouth delay the tip of the applicator in the mouth, to encourage swallowing. This will aid transport of the capsule to the rumen
- If using a sheep handling system, which prevents straddling the neck (e.g. conveyor), the dosing technique must be modified for safe dosing. Contact your veterinarian for specific advice

CONTROLLING THE ANIMAL

You must have complete control of the animal at all times, especially of its head and neck. Straddle the animal's neck while dosing. To do this, keep its head against your knees or thighs as in a head bail. Do not rush the dosing process, take time and care when administering capsules.

CORRECT ANGLE OF THE HEAD AND NECK

The angle of the head and neck must be straightened so the applicator in the mouth lines up with the throat. Obtain the correct angle by lifting every animal's chin and extending its neck (by allowing it to pull back against your thighs). Keep complete control of the head and neck while dosing (see illustration 2 below).

WARNING: With an incorrect angle or undue force, the operator can puncture the back of the throat causing death.

ENSURE SWALLOWING CONTINUES WHILE DOSING

While holding the animal's lower jaw, insert the capsule into the side of the mouth and onto the tongue avoiding contact with the teeth. The animal will start swallowing; swallowing must continue throughout the dosing process, and will cease if the head and neck are at the wrong angle, or if your dosing technique is incorrect.

WARNING: Slight resistance may be felt if the animal uses its tongue to block the capsule at the back of the mouth. Withdraw the capsule to restart swallowing. Allow the swallowing reflex to draw the capsule and applicator over the tongue and into the back of the throat. Keep the sheep's chin up. Don't use force as you may damage the throat causing fatal infection. Once the hilt of the applicator is at the corner of the mouth gently release the capsule. Observe the animal for a moment to ensure the capsule has been swallowed.

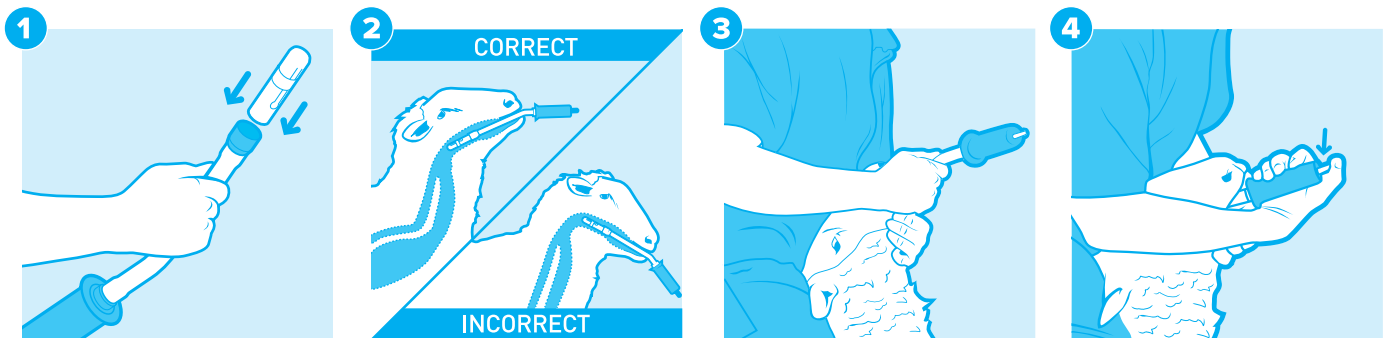

PROUDLY AVAILABLE FROM YOUR LOCAL PARTICIPATING VETERINARY CLINIC

See product label for full claim details and directions for use. BIONIC® is a registered trademark of Boehringer Ingelheim Vetmedica GmbH, used under license. ACVM Registration No. A011825. © Copyright 2025 Boehringer Ingelheim Animal Health New Zealand Limited. All rights reserved. NZ-OVI-0015-2025.

